

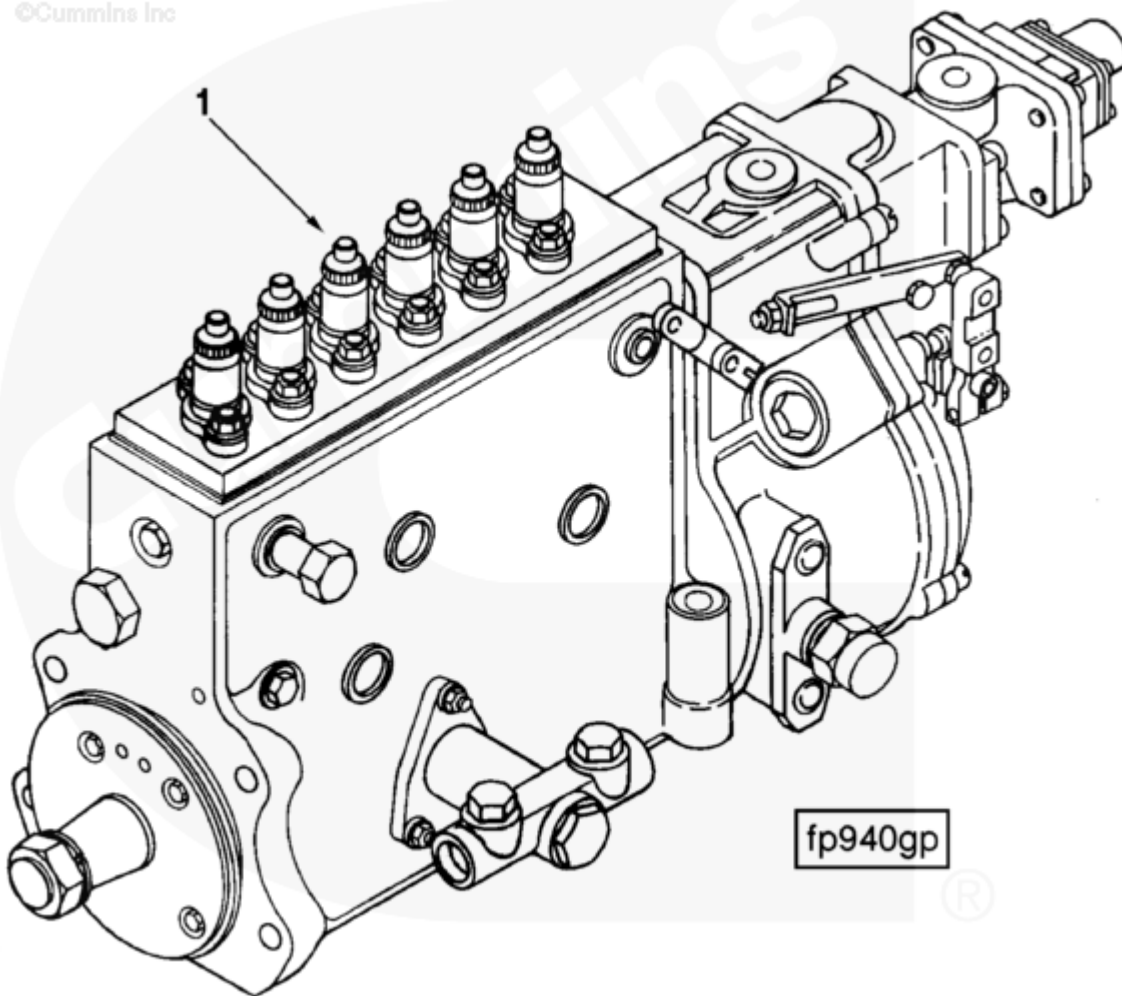

Parts Catalog - Option Detail

Electronic Parts Catalog - Option Detail				
Option	Group	Graphic	Film Card	Date
FP98617	05.21	fp940gp	Z	09-AUG-99
Engines	6C8.3, C GAS PLUS CM556, G8.3, G8.3 CM558, GTA8.3 CM558, ISC CM2150, ISC CM554, ISC CM850, ISC8.3 CM2250, ISC8.3 G CM2180 C101, ISL CM2150, ISL CM554, ISL CM850, ISL G CM2180, ISL8.9 CM2150 L110, ISL8.9 CM2880 L112, ISL9 CM2150 SN, ISL9 CM2250, ISL9 CM2350 L101, ISL9 CM2350 L111, ISLE4 CM850, L GAS PLUS CM556, L8.9, L8.9 L121, L8.9G CMOH2.0 L125B, L9 CM2350 L116B, L9 CM2350 L119B, L9 CM2350 L120C, L9 CM2350 L123B, L9.3 L105, L9.5 L117, L9N CM2380 L124B, QSC8.3 CM2250, QSC8.3 CM2880 C102, QSC8.3 CM554, QSC8.3 CM850(CM2850), QSL9 CM2250, QSL9 CM2250 L115, QSL9 CM2350 L102, QSL9 CM2350 L107, QSL9 CM2350 L118, QSL9 CM2350 L122, QSL9 CM554, QSL9 CM850(CM2850), QSL9 G CM558, QSL9 M CM2250 L106, QSL9.3 CM2880 L113			



[SMALL](#) | [MEDIUM](#) | [LARGE](#)

Cart	Ref No	Part Number	Part Description	Required	Remarks
View My Cart					
		FP98617	Base Fuel Pump		Fuel Pump...(More)

				Engine Family: C Series
				Engine Cylinders: 6
				Advertised HP: 317 @ 1800
				Governed HP: 317 @ 1800
				Fuel Pump Type: Inline
				Pump Manufacturer/Model:
				Bosch P3000
				High Idle: 2120
				Governor Type: RSV
				Solenoid Mtg Location:
				Remote
				High Pressure Tube ID (mm):
				2.0
				Shutdown Device: Electrical
				LDA Provision: No
				Latch-out Linkage Provision:
				Yes
				External Oiling Provision:
				No
				Compatible Fuel Rating - FR:
				90645
				CPL: 2664
				Certified by: CARB, EPA
				Certification Year: 1999
				Certification Status:
				Approved
				Peak Power: 317
				Governor Break RPM: 1920
				Governor Regulation (%):
				10.4

					Pump Shut-down Lever Design:
					Inboard Single Hole
					NOx Level: 6.0
					Shutdown Lever Hole Count: 1
					Engine Design Phase: Current
					Product
					Fuel Pump Mounted Angle: 25
					deg
					Fuel Pump Mounted Location:
					Front
					Bolt-on ELE. GOV. Capable:
					No
					For use with Electronic
					Governor only.
					Fuel drain line to pump
					connection is plumbed to
					inboard side of fuel pump.
<input type="checkbox"/>	1	3936546	Fuel Injection Pump	1	